



6022-Z Deep groove ball bearings

- SKF Explorer

Deep groove ball bearings

Bearing data

[Tolerances](#),
Normal (metric), P6, P5, Normal (inch),
[Radial internal clearance](#),
Matched bearing pairs, Stainless steel
 $d < 10$ mm, Other bearings

Bearing interfaces

[Seat tolerances for standard conditions](#),
[Tolerances and resultant fits](#)

Technical specification

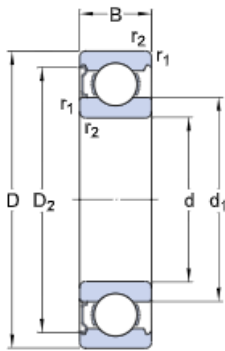

DIMENSIONS

d	110 mm	Bore diameter
D	170 mm	Outside diameter
B	28 mm	Width
d_1	≈ 129.05 mm	Shoulder diameter
D_2	≈ 155.3 mm	Recess diameter
$r_{1,2}$	min. 2 mm	Chamfer dimension

ABUTMENT DIMENSIONS

d_{ξ} min.	119 mm	Diameter of shaft abutment
d_{ξ} max.	128.9 mm	Diameter of shaft abutment
D_{ξ} max.	161 mm	Diameter of housing abutment
r_a max.	2 mm	Radius of shaft or housing fillet

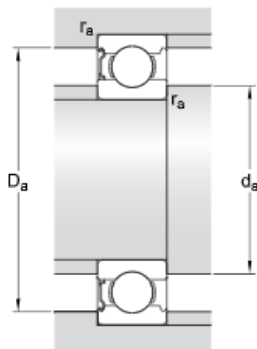

CALCULATION DATA

C	85.2 kN	Basic dynamic load rating
C ₀	73.5 kN	Basic static load rating
P _u	2.6 kN	Fatigue load limit
	8 000 r/min	Reference speed
	5 000 r/min	Limiting speed
k _r	0.025	Minimum load factor
f ₀	15.6	Calculation factor

MASS

	2 kg	Mass bearing
--	------	--------------

TOLERANCE CLASS

P6	Dimensional tolerances
Normal	Radial run-out